

TOWN AND COUNTRY PLANNING ACT 1990 - SECTION 257

CITY OF BRADFORD METROPOLITAN DISTRICT COUNCIL

PUBLIC PATH ORDER

HILLCREST ROAD, QUEENSBURY

This Order is made by City of Bradford Metropolitan District Council under section 257 of the Town and Country Planning Act 1990 because it is satisfied that it is necessary to stop up the footpath to which this Order relates in order to enable development to be carried out in accordance with planning permission granted under Part III of the Town and Country Planning Act 1990, to enable the development of new homes to be built across the route of the path.

BY THIS ORDER:

1. The footpath over the land shown by a bold black line on the attached map and described in Part 1 of the Schedule to this Order ("the Schedule") shall be stopped up as provided below.
2. The alternative highway shall be improved to the reasonable satisfaction of City of Bradford Metropolitan District Council for use as a replacement for the said footpath as provided in Part 2 of the Schedule and shown by bold black dashes on the attached map.

The footpath over the land described in Part 3 of the Schedule and shown hatched black on the attached map shall be improved to the reasonable satisfaction of City of Bradford Metropolitan District Council by installation of tarmac surface and fencing of the property to the improved path not exceeding a height of 1.1 metres to the front of the property.

3. The stopping up of the footpath shall have effect on the confirmation of this order.
4. The following works shall be carried out in relation to the highway described in Part 3 of the Schedule: The path will have a tarmac surface installed. The fencing of the property adjacent to the improved path will have a wooden fence of hit and miss construction. This will not exceed a height of 1.1m to the front of the property.
5. J.M. Development (Halifax) Limited is hereby required to pay for the cost of carrying out the said works.
6. Where immediately before the date on which the footpath is stopped up there is apparatus under, in, on, over, along or across it belonging to statutory undertakers for the purpose of carrying on their undertaking, the undertakers shall continue to have the same rights in respect of the apparatus as they then had.

SCHEDULE

Part 1

Description of site of existing path or way

Path to be closed (A-B)

Part of Queensbury 212 commencing at point A proceeding in a north east direction for 27.4 metres to point B. The path is 2 metres wide, with a tarmac surface for the first 7.5 metres from Hillcrest Road and a grass and soil surface for the remaining 19.9 metres as indicated on the map.

Part 2

Description of site of alternative highway

Part 3

Description of existing highway to be improved

Path to be improved (C-D)

The existing highway path shall be improved for use as a replacement for the said footpath. The path will have a tarmac surface installed. The fencing of the property adjacent to the improved path will have a wooden fence of hit and miss construction. This will not exceed a height of 1.1m to the front of the property.

**THE COMMON SEAL of CITY OF
BRADFORD METROPOLITAN
DISTRICT COUNCIL**

was hereunto affixed on this
15th day of September 2022
in the presence of:-

H. Day

Authorised by the City Solicitor



101906 A

In pursuance of the powers in that behalf conferred by Section 257 of the Town and Country Planning Act 1990 the Council hereby confirms the foregoing Order.

**THE COMMON SEAL of CITY OF
BRADFORD METROPOLITAN
DISTRICT COUNCIL**

was hereunto affixed on this
day of
in the presence of:-

Authorised by the City Solicitor



410700

410800

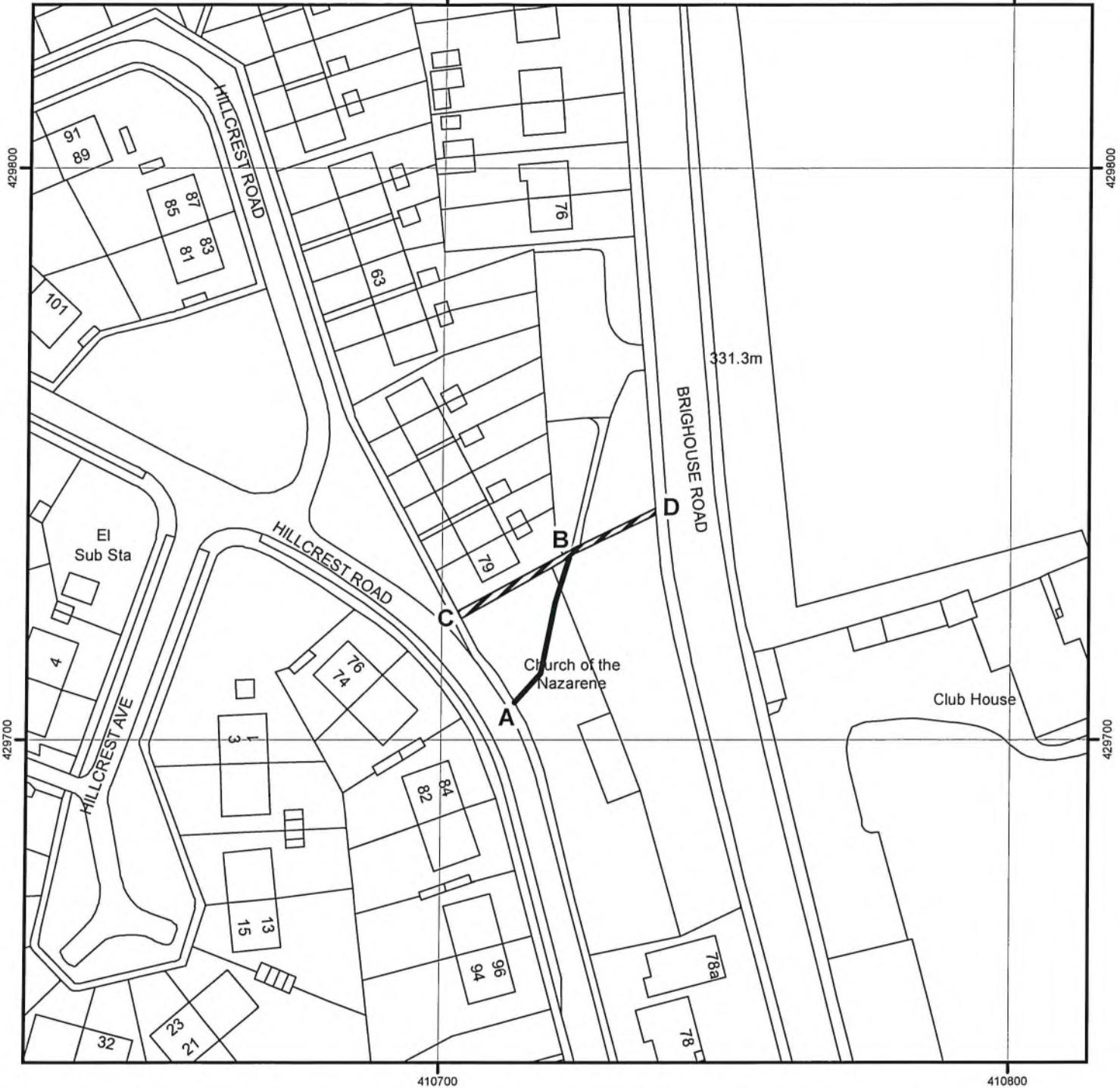

Proposed Public Path Order to stop up a section of Public Footpath No. 212 (Queensbury) between Hillcrest Road and Brighouse Road, Queensbury
Under Section 257 Town and Country Planning Act 1990

M. Dugg

Legend

- A ——— B Footpath to be stopped up
- c d Existing highway to be improved

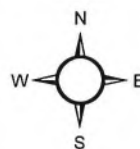

Scale	1:1000
OS Sheet	SE 1029
Drawn By	FP
Checked By	TB
Date	29/06/2022

Reference: 66666/T254/QUE212 Order Plan



Brighouse Road

Hillcrest Road

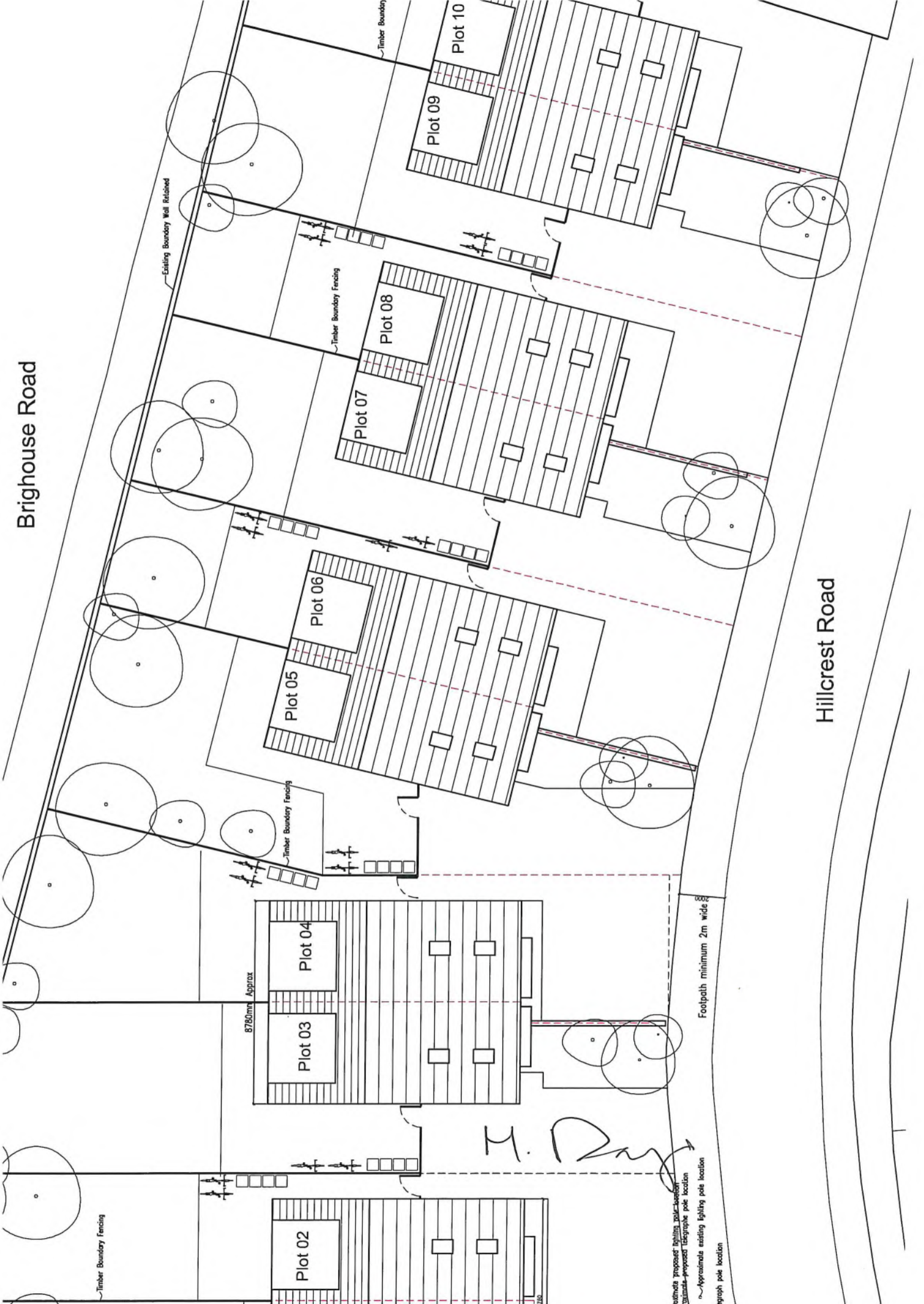

Timber Boundary Fencing

Existing Boundary Wall Retained

Timber Boundary Fencing

Timber Boundary Fencing

Timber Boundary

8780mm Approx

Footpath minimum 2m wide

without proposed lighting pole location
proposed telegraph pole location
Approximate existing lighting pole location
existing pole location

M. D. J.

0 10 20

TOWN AND COUNTRY PLANNING ACT 1990 – SECTION 257

CITY OF BRADFORD METROPOLITAN DISTRICT COUNCIL

PUBLIC FOOTPATH NO. 212 QUEENSBURY

PUBLIC PATH ORDER 2022

ORDER

CORP/PCD/AK/411872

Made: 15th September 2022

Confirmed:

Coming into effect:

**Director of Legal & Governance
Legal and Democratic Services
City of Bradford Metropolitan District Council
City Hall
Bradford
BD1 1HY**